

K100 JIC

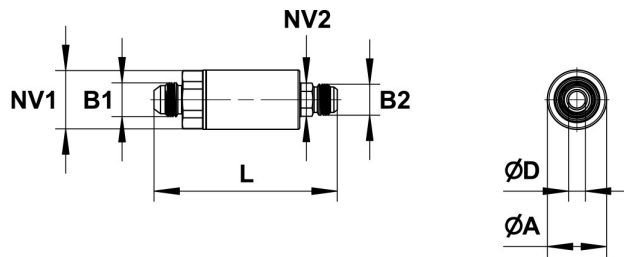

AUSSEN X AUSSEN

Teile Nr.	B1	B2	L	ØA	ØD	NV1	NV2	Max Arbeitsdruck	JIC Format	Dichtungssatz
9010038	3/4"-16 UNF	3/4"-16 UNF	109 mm	35 mm	10 mm	32 mm	17 mm	45 MPa	8	6003296
9010061	1 1/16"-12 UN	1 1/16"-12 UN	132 mm	43 mm	15,5 mm	36 mm	24 mm	45 MPa	12	6002516
9010062	1 5/16"-12 UN	1 5/16"-12 UN	142 mm	50 mm	20 mm	46 mm	30 mm	45 MPa	16	6002517

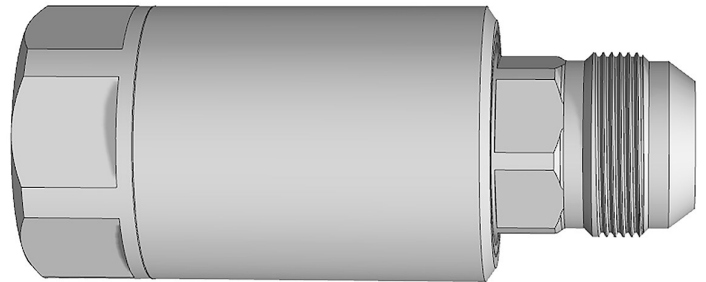
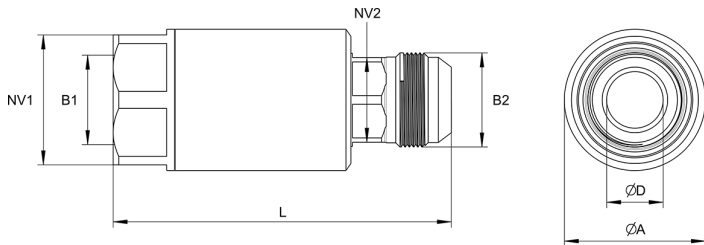

INNEN X AUSSEN

Teile Nr.	B1	B2	L	ØA	ØD	NV1	NV2	Max Arbeitsdruck	JIC Format	Dichtungssatz
9010005	1 1/16"-12 UN	1 1/16"-12 UN	117 mm	43 mm	16 mm	36 mm	24 mm	45 MPa	12	6002516
9010006	1 5/16"-12 UN	1 5/16"-12 UN	119 mm	50 mm	20 mm	46 mm	30 mm	45 MPa	16	6002517
9010057	3/4"-16 UNF	3/4"-16 UNF	98 mm	35 mm	10 mm	32 mm	17 mm	45 MPa	8	6003296
9010058	7/8"-14 UNF	7/8"-14 UNF	101 mm	37 mm	12 mm	32 mm	21 mm	45 MPa	10	6002515

JIC-Konus außen, 37°

JIC-innen, SAE O-Ring

Temperaturbereich (Standard) = -30° C - +100° C